

Bala Falls Power Station

- Mitchell Shnier
 - Family on Long Lake for 35 years
 - Not a civil or mechanical engineer
 - Input has been carefully reading documents and talking to the company and others
- Long-term concerns

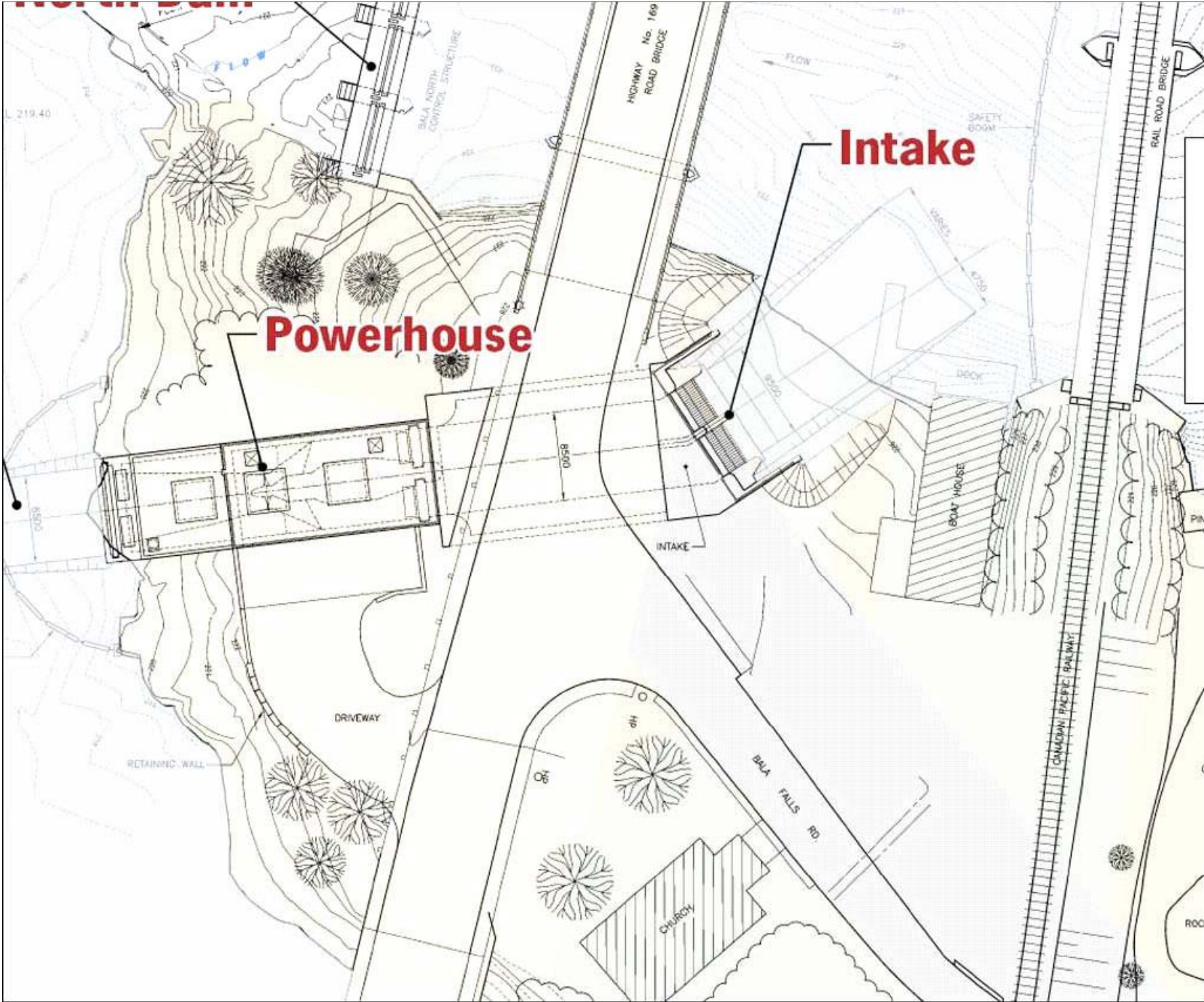



Moon River

Bala Bay
(Lake Muskoka)

HWY 169

BALA ROAD

THE SUNSET DECK
 PROMENADE WITH
 LATTICE & BENCHES
 WITH A GRAND VIEW
 DOWN RIVER
 INTERPRETIVE
 PANELS INTEGRATED
 INTO RAILINGS

HIDDEN
 LOWER LEVEL
 VIEWING/REST
 AREA ON HATCH

INTERPRETIVE PANELS

- HISTORICAL & CULTURAL HERITAGE OF BALA
- NATURAL WORLD - BIRDS, TREES, FISH
- INDUSTRIAL HERITAGE - BALA POWER

GATEWAY

- GATEWAY**
- FOOT PATH DOWN TO SUNSET DECK
 - GENTLE SLOPE = ACCESSIBILITY

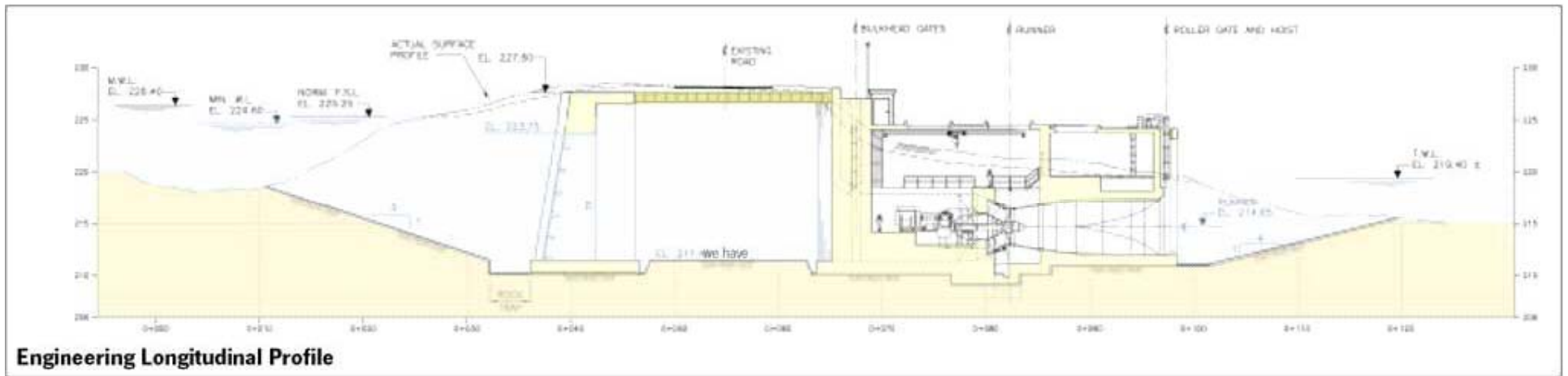



* NEW LANDSCAPING, UTILIZING BEST ROCK + PLANTINGS FROM LOCAL AREAS + NATURAL 'MUSKOGEE-STYLE' SCENE ATTRICTION.

* CRUISED STONE PATHWAYS WOULD BE BETWEEN ROCK OUTCROPS AND GUIDE VISUALS DOWN THROUGH THE NATURAL ROCK TO THE RIVER'S EDGE.

* INTERMEDIATE PLANTS ON LOCAL HIGHWAY, PLANTS + TREES ARE LOCATED IN VIEWING ZONES ALONG THE PATHWAYS.

* GATEWAYS SIGNAL ACCESSIBLE PATHWAYS DOWN TO THE SUNSET DECK

THE SUNSET DECK

* MUSKOGEE-STYLE PROMENADE WITH INTERESTING INTERPRETIVE PANELS

* WOOD STRUCTURES + GLASS RAILING PROVIDE OPEN VIEWS ACROSS THE PARK + UP THE RIVER

* AREA IS SUITABLE FOR RECEPTIONS + GROUP MEETINGS

EL. 227.00

HWY 169

6-7m

EL. 224.5

5m +/-

Moon River



Concerns – Process

- Approval is being sought while important details are still unknown
 - Understood that detailed engineering has not been completed, but how can approval be granted with important details unknown
 - How much water will go over the south dam
 - Will there be anything worth looking at
 - What will north side of power station look like
 - Will vegetation grow over the power station or on the rock slope

Concerns – Safety

- Water intake
 - Efforts are being made to minimize this (safety boom, reduced water speed)
 - But people jumping off the railway bridge have shown they don't care about rules
 - Accidents are more likely to be fatal than for the current dams
- Moon River viewing platform is 15' to 18' above the river
 - A tempting new place from which to jump
 - Would land within the safety boom – which is supposed to keep people out of that area
 - That height and jumping danger may require substantial fence – detracting from the view

Concerns – Safety

- Stairway to entrance
 - Goes down 15 ‘
 - Or requires concrete hut at highway
- 18' steep rock slope
 - Would either require a fence (which entirely changes the project)
 - Or need to be a long dirt hill to falls

Concerns – Appearance

- 28' x 15' solid steel gate on a 33'-wide concrete structure faces the Moon River
 - Efforts will be made to make this look nicer
- Most of land to south of power house will be driveway
 - With at least a rope, to prevent the public from parking
- Much of land above power house will be concrete hatches
 - Three, each 13' x 13' , covered with deck boards
- Is only “buried” at the highway, continues level to the Moon River, where it will be 15' to 18' above river

Concerns – Appearance

- Ventilation intakes and exhaust louvers are needed
- Safety booms in Bala Bay (probably two) and Moon River
 - Probably fluorescent orange
- Intake will be concrete with a fence from the highway to Bala Bay
 - 48' wide, rising to 6' to 8.5' above water

Next Steps

- If a Power Station can't be integrated into the existing surroundings
 - Ministry of Natural Resource's interests are protecting pristine wilderness, not Bala
 - Show safety issues
 - Show tourism issues
 - Show solving these (if even possible) would further increase the costs of the project

- Mitchell Shnier
- Mitchell@shnier.com
- 416 222-1430