

Stage 1
Mobilize and prepare construction staging area.

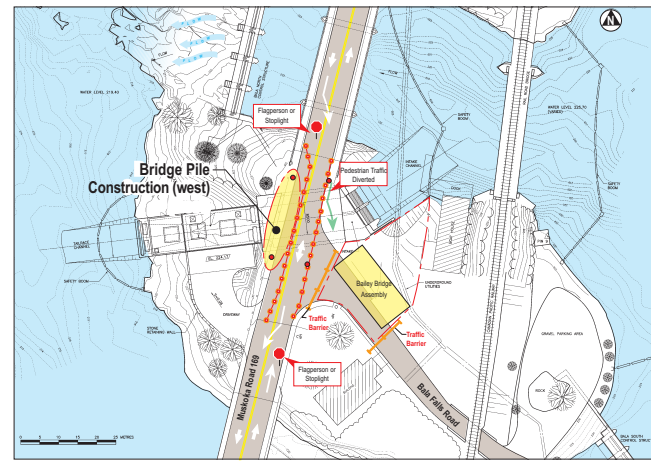

Stage 2a
Prepare Bailey Bridge west piles. Assemble Bailey Bridge on Bala Falls Road. (approximately one week duration)

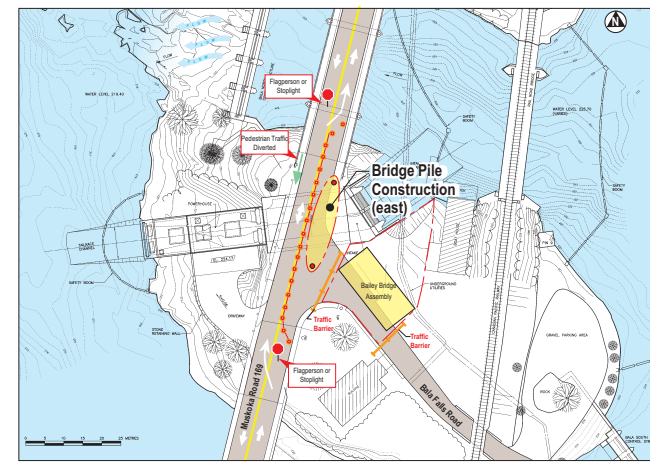

Stage 2b
Prepare Bailey Bridge east piles. Assemble Bailey Bridge on Bala Falls Road. (approximately one week duration)

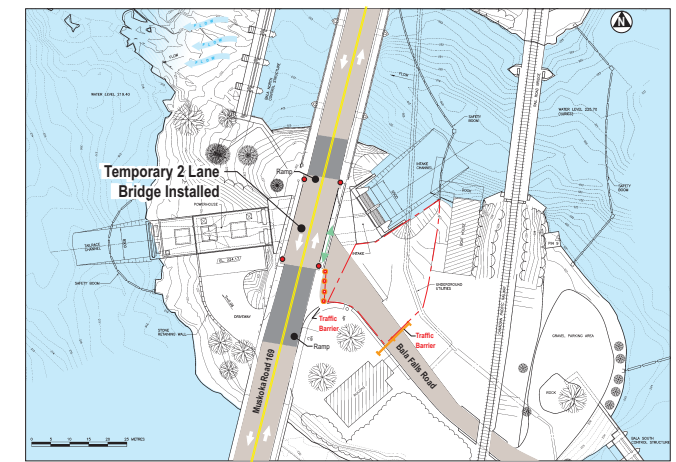

Stage 3
Crane places temporary Bailey Bridge on Highway 169 with end ramps. (one night shift - closure)

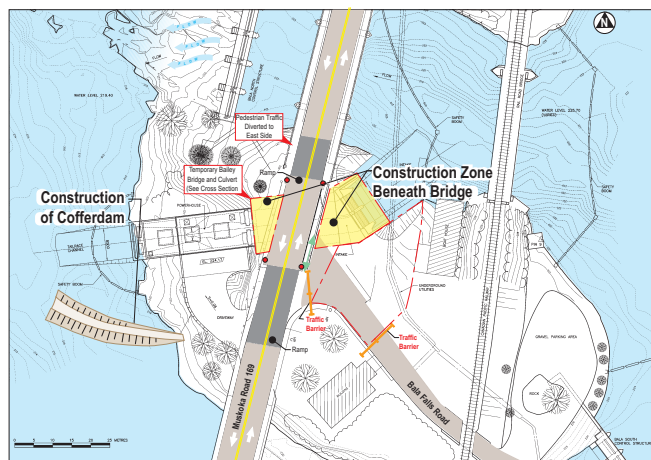

Stage 4
Construct box culvert beneath Bailey Bridge using cut and cover approach. Excavated material to downstream cofferdam.

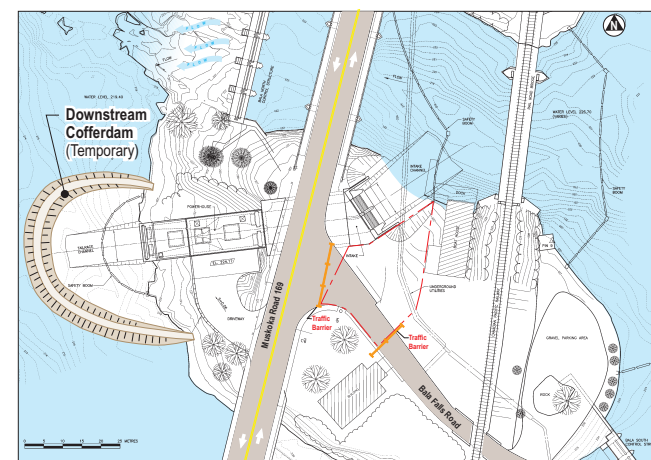

Stage 5/6
Crane removes temporary Bailey Bridge, final road fill placed. Highway 169 fully open for remainder of project. (1 night shift - closure ~ 4 hrs.)

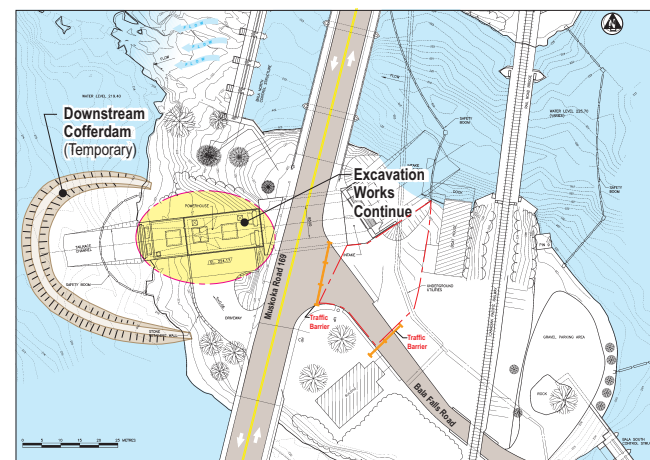

Stage 7
Excavate for powerhouse.

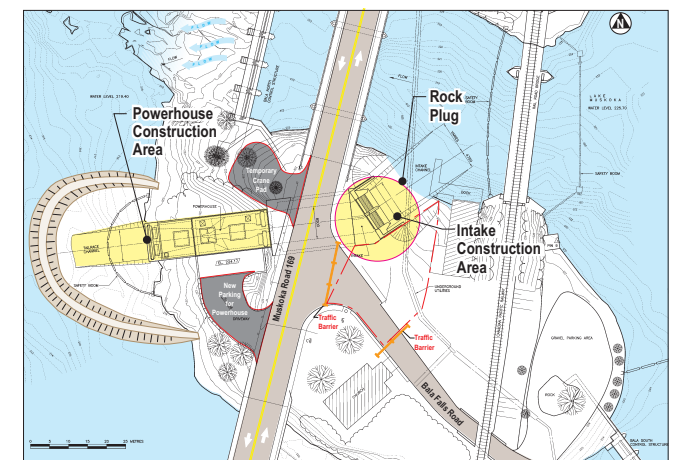

Stage 8
Construct Powerhouse and Intake. (Intake channel to be excavated in water-blasting coinciding with rock plug removal)

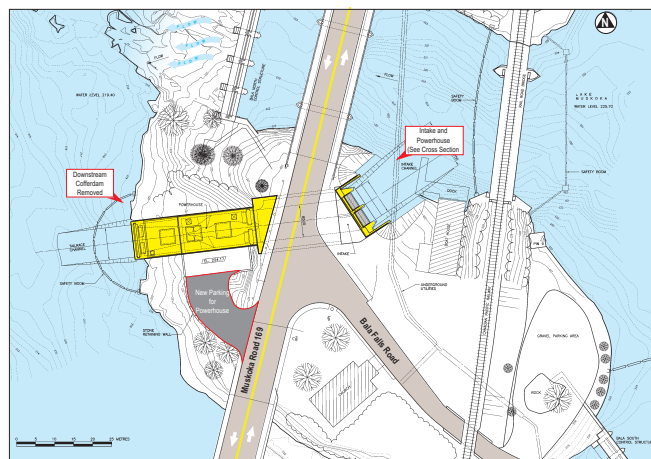

Stage 9
Commission generating facilities.

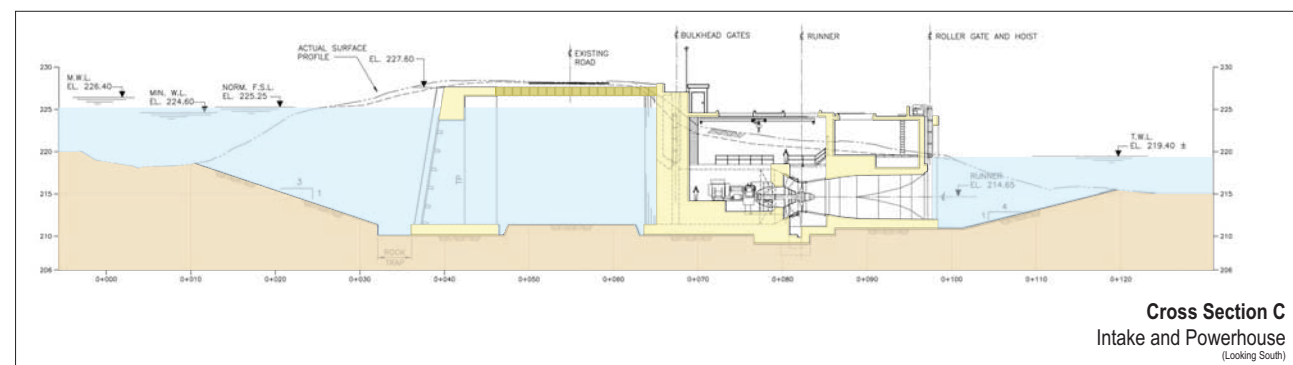
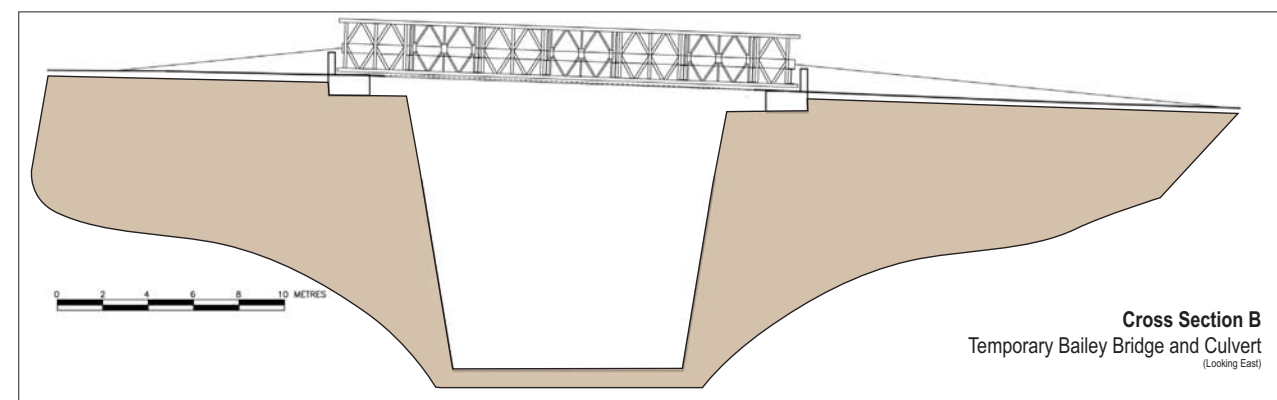
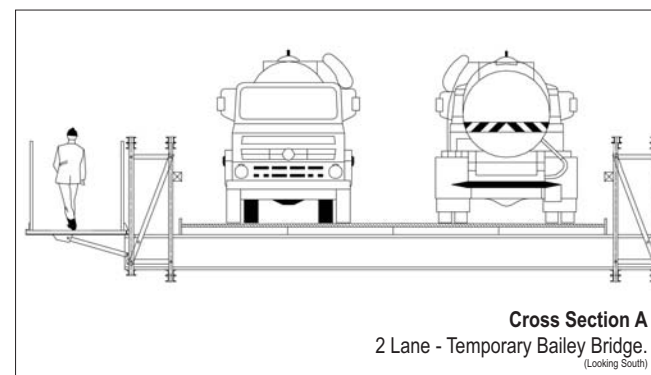

Figure 5.1
Swift River Energy Ltd.
North Bala Small Hydro Project
Traffic / Construction Sequence

